

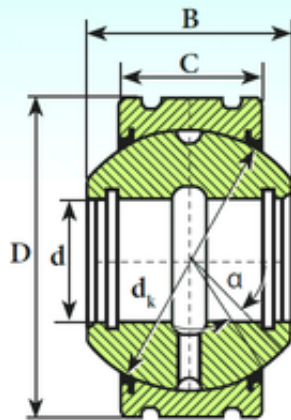

ISO BEARING-SINGAPORE (PTE)LTD.



35 mm x 80 mm x 54 mm ISB GEK 35 XS 2RS
plain bearings

Bearing No. GEK 35 XS 2RS

Size	35x80x54 mm
Bore Diameter	35 mm
Outer Diameter	80 mm
Width	54 mm
d	35 mm
D	80 mm
B	54 mm
C	38 mm
dk	44,5 mm
Angle	17 °
Weight	1,23 Kg
Basic dynamic load rating (C)	226 kN

GEK 35 XS 2RS Bearing 2D drawings and 3D CAD
models