

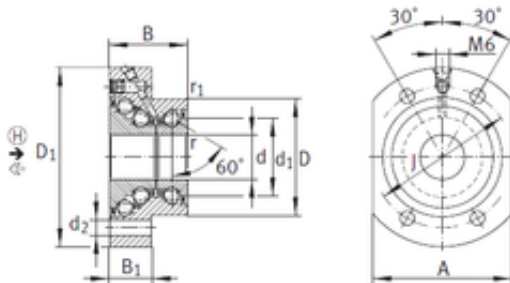

ISO BEARING-SINGAPORE (PTE)LTD.

20 mm x 52 mm x 35 mm INA
DKLFA2080-2RS thrust ball bearings



Bearing No. DKLFA2080-2RS

DKLFA2080-2RS Bearing 2D drawings and 3D CAD models

Size	20x52x35 mm
Bore Diameter	20 mm
Outer Diameter	52 mm
Width	35 mm
d	20 mm
D	52 mm
B	35 mm
C	35 mm
Angle (?)	60 °
d1	34,5 mm
d2	6,8 mm
r min.	0,3 mm
r1 min.	0,6 mm
A	62 mm
B1	19 mm
D1	80 mm
J	63 mm
Bolt (G)	M6
da min.	25 mm
da max	43 mm