

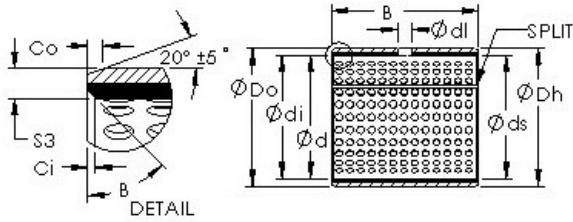

# ISO BEARING-SINGAPORE (PTE)LTD.



## AST AST20 120110 plain bearings

Bearing No. AST20 120110

Bore Diameter	120 mm
Outer Diameter	125 mm
Bearing Type	straight
Shaft Dia., Nominal (d)	120.0000
Shaft Size (ds) - 120 +0 / -0.054	120 +0 / 0.054
Housing Bore Dia. (Dh) - 125 +0.040 / -0	125 +0.040 / 0
Bearing Outside Diameter, Nominal(Do)	125.000
Bearing Outside Diameter Tolerance (Do tol.)	125.170 / 125.100
Bearing Bore after Mounting (di)	120.270 / 120.110
Average Clearance (Cd)	0.2170
Wall Thickness (S3)	2.418
Bearing Length, Nominal (B)	110.000
Bearing Length Tolerance (B tol.) - +0 / -0.40	+0 / 0.40
OD Chamfer Length (Co)	1.800
ID Chamfer Angle (B deg.)	45
ID Chamfer Length (Ci)	0.800
Lube Hole Dia. (dl)	9.500
Material	Carbon steel shell with POM plastic liner

AST20 120110 Bearing 2D drawings and 3D CAD models