

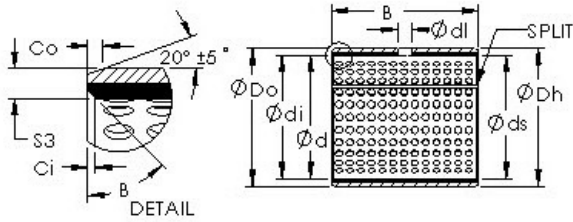

ISO BEARING-SINGAPORE (PTE)LTD.



AST AST20 250120 plain bearings

Bearing No. AST20 250120

Bore Diameter	250 mm
Outer Diameter	255 mm
Bearing Type	straight
Shaft Dia., Nominal (d)	250.0000
Shaft Size (ds) - 250 +0 / -0.072	250 +0 / 0.072
Housing Bore Dia. (Dh) - 255 +0.052 / -0	255 +0.052 / 0
Bearing Outside Diameter, Nominal(Do)	255.000
Bearing Outside Diameter Tolerance (Do tol.)	255.260 / 255.170
Bearing Bore after Mounting (di)	250.282 / 250.110
Average Clearance (Cd)	0.2320
Wall Thickness (S3)	2.418
Bearing Length, Nominal (B)	120.000
Bearing Length Tolerance (B tol.) - +0 / -0.40	+0 / 0.40
OD Chamfer Length (Co)	1.800
ID Chamfer Angle (B deg.)	45
ID Chamfer Length (Ci)	0.800
Lube Hole Dia. (dl)	9.500
Material	Carbon steel shell with POM plastic liner

AST20 250120 Bearing 2D drawings and 3D CAD models