

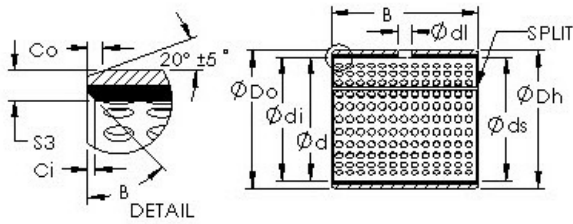

# ISO BEARING-SINGAPORE (PTE)LTD.

## AST AST20 48IB48 plain bearings



Bearing No. AST20 48IB48

Bore Diameter	76,2 mm
Outer Diameter	80,9752 mm
Bearing Type	straight
Shaft Dia., Nominal (d)	3.0000
Shaft Size (ds)	2.9849 / 2.9831
Housing Bore Dia. (Dh)	3.1889 / 3.1875
Bearing Outside Diameter, Nominal(Do)	3.188
Bearing Bore after Mounting (di)	2.9959 / 2.9893
Average Clearance (Cd)	0.0090
Wall Thickness (S3)	0.098
Bearing Length, Nominal (B)	3.000
Bearing Length Tolerance (B tol.) - +.010 / -0.010	+0.010 / 0.010
OD Chamfer Length (Co)	0.070
ID Chamfer Angle (B deg.)	45
ID Chamfer Length (Ci)	0.031
Lube Hole Dia. (dl)	0.375
Material	Carbon steel shell with POM plastic liner

AST20 48IB48 Bearing 2D drawings and 3D CAD models