

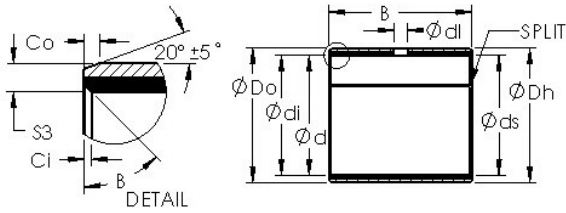

ISO BEARING-SINGAPORE (PTE)LTD.



AST AST50 061B03 plain bearings

Bearing No. AST50 061B03

Bore Diameter	9,525 mm
Bearing Type	straight
Shaft Dia., Nominal (d)	0.3750
Shaft Size (ds) - 0.374	0.3731
Housing Bore Dia. (Dh) - 0.4691	0.4684
Bearing Bore after Mounting (di) - 0.3769	0.3742
Average Clearance (Cd)	0.0020
Wall Thickness (S3)	0.047
Bearing Length, Nominal (B)	0.188
Bearing Length Tolerance (B tol.) - +.010 / -0.010	+0.010 / 0.010
OD Chamfer Length (Co)	0.023
ID Chamfer Angle (B deg.)	30
ID Chamfer Length (Ci)	0.014
Material	Carbon steel shell with PTFE / Fiber lining

AST50 061B03 Bearing 2D drawings and 3D CAD models