

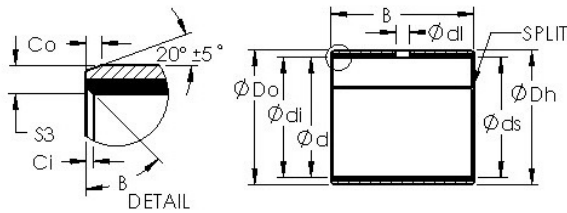

ISO BEARING-SINGAPORE (PTE)LTD.



AST AST40 1310 plain bearings

Bearing No. AST40 1310

Bore Diameter	13 mm
Outer Diameter	15 mm
Bearing Type	straight
Shaft Dia., Nominal (d)	13.0000
Shaft Size (ds) - 13 -0.016 / -0.034	13 0.016 / 0.034
Housing Bore Dia. (Dh)	15 +0.018 / +0
Bearing Outside Diameter, Nominal(Do)	15.000
Bearing Outside Diameter Tolerance (Do tol.)	15.065 / 15.03
Bearing Bore after Mounting (di)	13.058 / 12.99
Average Clearance (Cd)	0.0490
Wall Thickness (S3)	1.005
Bearing Length, Nominal (B)	10.000
Bearing Length Tolerance (B tol.) - +0 / -0.30	+0 / 0.30
OD Chamfer Length (Co)	0.600
ID Chamfer Angle (B deg.)	30
ID Chamfer Length (Ci)	0.300
Material	Steel shell with PTFE / Polymer Fiber lining

AST40 1310 Bearing 2D drawings and 3D CAD models