

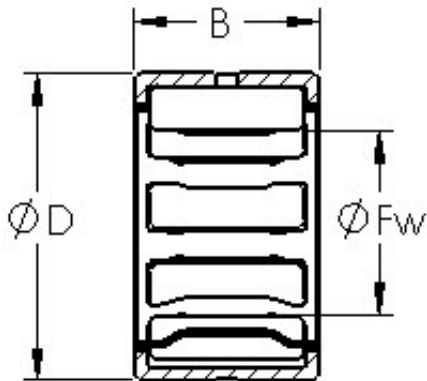

# ISO BEARING-SINGAPORE (PTE)LTD.



## AST NCS1616 needle roller bearings

Bearing No. NCS1616

Bore Diameter	25,4 mm
Outer Diameter	38,1 mm
Width	25,4 mm
Bearing Type	needle roller bearing
Outer Dia (D)	1.5000
Width (B)	1.0000
Dynamic Load Rating (Cr)	7,200
Static Load Rating (Cor)	10,000
Max Speed (Oil) (X1000 RPM)	17,000
Shaft (Fw)	1.000
Weight (g)	91.00
Material	52100 Chrome steel, or equivalent

NCS1616 Bearing 2D drawings and 3D CAD models