

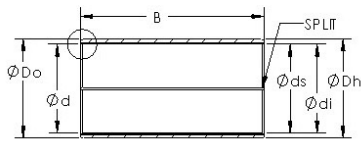

# ISO BEARING-SINGAPORE (PTE)LTD.

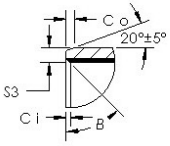

## AST AST850BM 2625 plain bearings

Bearing No. AST850BM 2625

Bore Diameter	26 mm
Outer Diameter	30 mm
Bearing Type	metal with bronze
Shaft Dia., Nominal (d)	26.0000
Shaft Size (ds) - 26 +0 / -0.033	26 +0 / 0.033
Housing Bore Dia. (Dh) - 30 +0.021 / -0	30 +0.021 / 0
Bearing Outside Diameter, Nominal(Do)	30.000
Bearing Bore after Mounting (di)	26 +0.181 / +0.040
Average Clearance (Cd)	0.1270
Wall Thickness (S3)	1.950
Bearing Length, Nominal (B)	25.000
Bearing Length Tolerance (B tol.) - +0 / -0.40	+0 / 0.40
OD Chamfer Length (Co)	1.200
ID Chamfer Angle (B deg.)	35
ID Chamfer Length (Ci)	0.500

AST850BM 2625 Bearing 2D drawings and 3D CAD models