

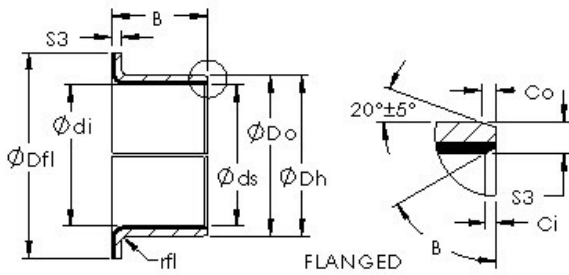

# ISO BEARING-SINGAPORE (PTE)LTD.



## AST AST50 24FIB16 plain bearings

Bearing No. AST50 24FIB16

Bore Diameter	38,1 mm
Bearing Type	flanged
Shaft Dia., Nominal (d)	1.5000
Shaft Size (ds) - 1.4988	1.4972
Housing Bore Dia. (Dh) - 1.6568	1.6558
Bearing Bore after Mounting (di) - 1.5028	1.499
Average Clearance (Cd)	0.0029
Wall Thickness (S3)	0.079
Bearing Length, Nominal (B)	1.000
Bearing Length Tolerance (B tol.) - +.010 / -0.010	+0.010 / 0.010
OD Chamfer Length (Co)	0.045
ID Chamfer Angle (B deg.)	30
ID Chamfer Length (Ci)	0.020
Flange Dia. (Dfl pm 0.5)	2.000
Flange Thickness (Sfl)	0.078
Flange Radius (rfl)	0.060
Material	Carbon steel shell with PTFE / Fiber lining

AST50 24FIB16 Bearing 2D drawings and 3D CAD models