

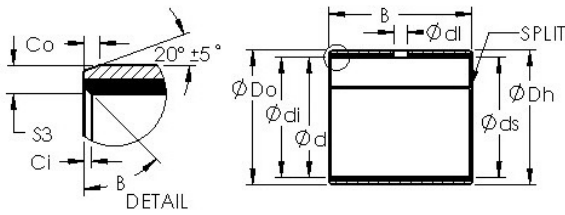

# ISO BEARING-SINGAPORE (PTE)LTD.



## AST AST40 20060 plain bearings

Bearing No. AST40 20060

Bore Diameter	200 mm
Outer Diameter	205 mm
Bearing Type	straight
Shaft Dia., Nominal (d)	200.0000
Shaft Size (ds) - 200 -0 / -0.072	200 0 / 0.072
Housing Bore Dia. (Dh)	205 +0.046 / +0
Bearing Outside Diameter, Nominal (Do)	205.000
Bearing Outside Diameter Tolerance (Do tol.)	205.21 / 205.13
Bearing Bore after Mounting (di)	200.216 / 200.07
Average Clearance (Cd)	0.1790
Wall Thickness (S3)	2.465
Bearing Length, Nominal (B)	60.000
Bearing Length Tolerance (B tol.) - +0 / -0.40	+0 / 0.40
OD Chamfer Length (Co)	1.800
ID Chamfer Angle (B deg.)	45
ID Chamfer Length (Ci)	0.600
Material	Steel shell with PTFE / Polymer Fiber lining

AST40 20060 Bearing 2D drawings and 3D CAD models