

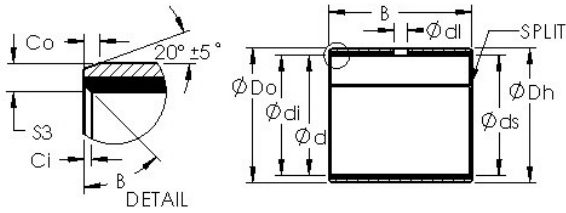

ISO BEARING-SINGAPORE (PTE)LTD.



AST AST11 9580 plain bearings

Bearing No. AST11 9580

Bore Diameter	95 mm
Outer Diameter	100 mm
Bearing Type	straight
Shaft Dia., Nominal (d)	95.0000
Shaft Size (ds) - 95 -0 / -0.054	95 0 / 0.054
Housing Bore Dia. (Dh)	100 +0.035 / +0
Bearing Outside Diameter, Nominal(Do)	100.000
Bearing Outside Diameter Tolerance (Do tol.)	100.12 / 100.07
Bearing Bore after Mounting (di)	95.155 / 95.05
Average Clearance (Cd)	0.1150
Wall Thickness (S3)	2.490
Bearing Length, Nominal (B)	80.000
Bearing Length Tolerance (B tol.) - +0 / -0.40	+0 / 0.40
OD Chamfer Length (Co)	1.800
ID Chamfer Angle (B deg.)	45
ID Chamfer Length (Ci)	0.600
Material	Bronze shell with PTFE / Fiber lining

AST11 9580 Bearing 2D drawings and 3D CAD models