

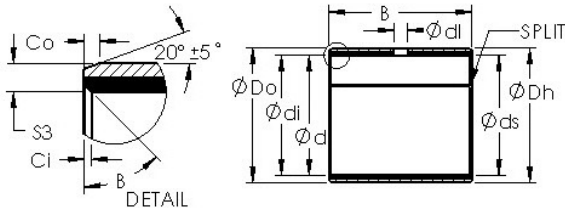

# ISO BEARING-SINGAPORE (PTE)LTD.



## AST AST40 1010 plain bearings

Bearing No. AST40 1010

Bore Diameter	10 mm
Outer Diameter	12 mm
Bearing Type	straight
Shaft Dia., Nominal (d)	10.0000
Shaft Size (ds) - 10 -0.013 / -0.028	10 0.013 / 0.028
Housing Bore Dia. (Dh)	12 +0.018 / +0
Bearing Outside Diameter, Nominal(Do)	12.000
Bearing Outside Diameter Tolerance (Do tol.)	12.065 / 12.03
Bearing Bore after Mounting (di)	10.058 / 9.99
Average Clearance (Cd)	0.0450
Wall Thickness (S3)	1.005
Bearing Length, Nominal (B)	10.000
Bearing Length Tolerance (B tol.) - +0 / -0.30	+0 / 0.30
OD Chamfer Length (Co)	0.600
ID Chamfer Angle (B deg.)	30
ID Chamfer Length (Ci)	0.300
Material	Steel shell with PTFE / Polymer Fiber lining

AST40 1010 Bearing 2D drawings and 3D CAD models