

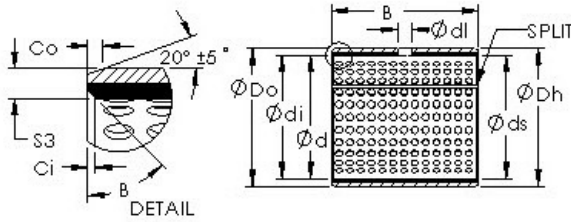

ISO BEARING-SINGAPORE (PTE)LTD.



AST AST20 201B12 plain bearings

Bearing No. AST20 201B12

Bore Diameter	31,75 mm
Outer Diameter	35,7124 mm
Bearing Type	straight
Shaft Dia., Nominal (d)	1.2500
Shaft Size (ds)	1.2387 / 1.2371
Housing Bore Dia. (Dh)	1.4072 / 1.4062
Bearing Outside Diameter, Nominal(Do)	1.406
Bearing Bore after Mounting (di)	1.2452 / 1.2414
Average Clearance (Cd)	0.0050
Wall Thickness (S3)	0.082
Bearing Length, Nominal (B)	0.750
Bearing Length Tolerance (B tol.) - +.010 / -0.010	+0.010 / 0.010
OD Chamfer Length (Co)	0.045
ID Chamfer Angle (B deg.)	30
ID Chamfer Length (Ci)	0.020
Lube Hole Dia. (dl)	0.250
Material	Carbon steel shell with POM plastic liner

AST20 201B12 Bearing 2D drawings and 3D CAD models